

13. MODE B footswitch:

- ①It's the switch controlling MODE B's effects.
- ②Press the footswitch and hold to activate TAP TEMPO mode, then tap the footswitch twice to set the speed of MODE effects.

14. INPUT L Jack: please connect to this when it's mono mode, and please refer to the connection diagram for details.

15. INPUT R Jack

16. DC IN Jack: Power Jack(DC9V center minus)

17. OUTPUT L Jack: 1/4" L channel(mono track) output jack, used for connecting to output signal or amp.

18. OUTPUT R Jack: 1/4" R channel output jack, used for connecting to output signal or amp.

19. Ambience light: Please refer to number 20 to set up ambience light mode.

20. Ambience control switch

SYNC mode—the ambience light is blue light when the footswitch is turned on, the ambience light goes off when the footswitch is turned off.

ALWAYS mode—the ambience light is blue.

OFF mode—the ambience light is off.

IV. Connections:

1.Mono connection

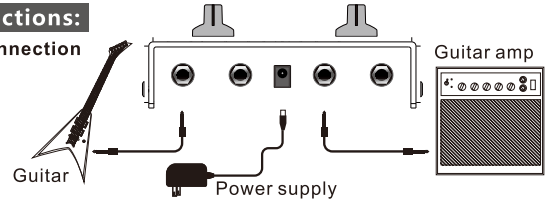

2.Stereo connection

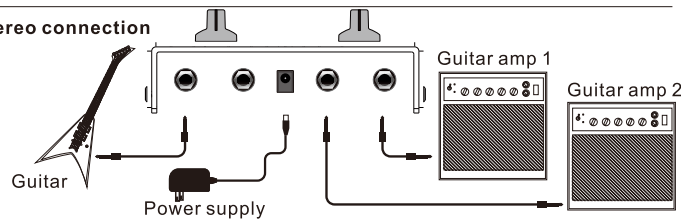

3.Stereo output effects pedals' connection

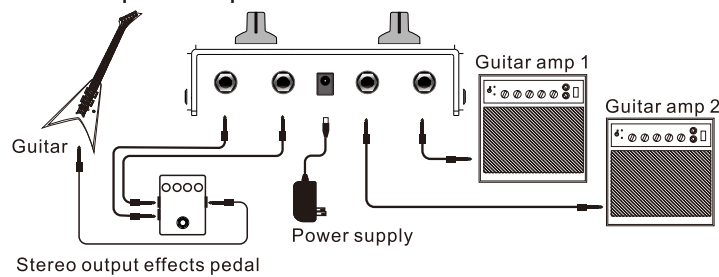

Thank you for purchasing this product!

In order to use this product properly and safely, please read this owner's manual carefully before operating this product, and keep it for future reference.

I .SAFETY INSTRUCTIONS:

- Don't apply excessive force to the switches or controls.
- Clean only with a clean dry cloth. Don't use inflammable substances such as benzene, thinner, detergent and so on.
- Do not place it in humid areas, so as to avoid damage to the internal circuits.
- The operating voltage is DC9V, don't exceed it, otherwise the product will malfunction.
- The power adapter is not included in the packing list, please buy it separately.
- Please make sure the polarity of your power adapter is the same with what is printed on its outer housing, any error on power polarity would cause damage to the product.
- Please turn on your amplifier after this product is powered on.
- Don't dump this product with household garbage. Proper treatment can reduce pollution and health hazards. Please contact your local dealer for correct approaches.

II.FEATURES:

- 2 independent MODE modules contain 18 modulation effects.
- Both MODE A and MODE B have its own independent adjustable parameters.
- 2 different connections ensure various tone combinations.
- Independent TAP speed setting function.
- Features stereo output.

III.Parts names & functions:

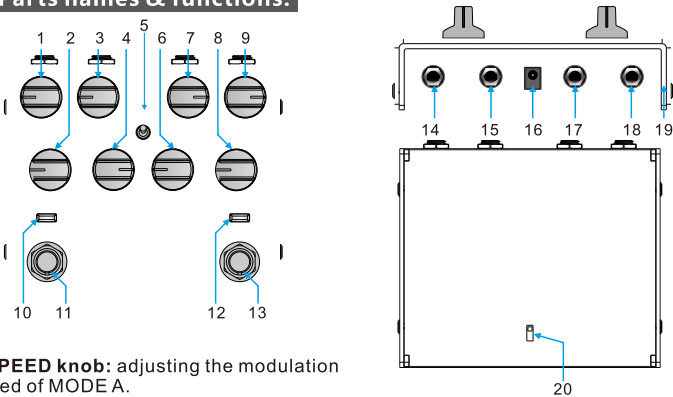

- 1.SPEED knob:** adjusting the modulation speed of MODE A.
- 2.TYPE A knob:** 9 modulation effects of MODE A for your choice.
- 3.CONTROL knob:** adjusting MODE A's MODE effects characteristics.
- 4.DEPTH/MIX knob:** adjusting MODE A's MODE effects depth and mix percentage.
- 5.TOGGLE SWITCH:** choose MODE A and MODE B's connection.(Please refer to the detailed routing method)
- 6.DEPTH/MIX knob:** adjusting MODE B's MODE effects depth and mix percentage.
- 7.RATE knob:** adjusting the modulation speed of MODE B.
- 8.TYPE B knob:** 9 modulation effects of MODE B for your choice.
- 9.CONTROL knob:** adjusting MODE B's MODE effects characteristics.
- 10.MODE A's working status indicator:** the indicator is in blue when MODE A is on, once the TAP TAMPO is activated, the indicator is in blue and start flickering, indicating the current tempo rate.
- 11.MODE A's footswitch:**

- ①It's the switch controlling MODE A's effects.
- ②Press the footswitch and hold to activate TAP TEMPO mode, then tap the footswitch twice to set the speed of MODE effects.
- 12. MODE B's working indicator:** when MODE B is turned on, the indicator is in blue, after the TAP TAMPO is activated, the indicator is in blue and start flickering, indicating the current tempo rate.

V.Routing:

There are 2 ways to connect MODE A and MODE B:



Turn on MODE A and MODE B simultaneously, it means AB is in parallel connection:

Turn off MODE A, while turn on MODE B, dry sound is in parallel connection with B:

Turn on MODE A, turn off MODE B, the dry sound is in parallel connection with A:

VI.Specifications:

Input: 1/4" mono audio interface x2(impedance1M Ohms)
 Output: 1/4" mono audio interface x2(impedance100 Ohms)
 Sample rate: 44.1K
 Sampling accuracy: 24bit
 Power supply: DC 9V(center minus)
 Current: 170mA
 Dimensions: 130*110*50mm
 Weight: 425g

*Disclaimer: any specification's update won't be amended in this manual.

JOYO TECHNOLOGY CO.,LTD

Address: 2/F, Lushi Industry Building, 28th District, Bao'an, Shenzhen, 518101 China.
www.joyo-amps.com Email:info@joyoaudio.com Tel: 0086-755-29765381

JOYO Technology is committed to guarantee the highest quality standards. All Technical Parameters or pictures are only for your information. Actual products.



四. 连接示意:

1. Mono连接

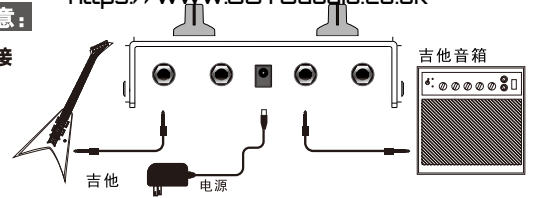

2. Stereo连接

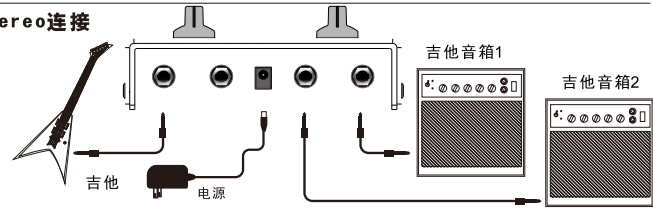

3. 立体声输出效果器接法

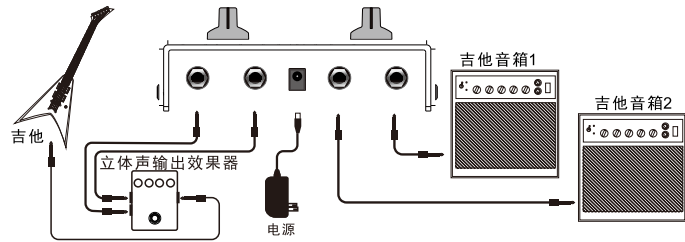

五. 线路连接:

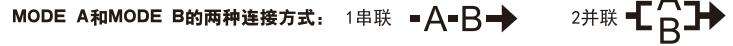

六. 规格参数:

输入: 1/4"单声道音频接口x2 (阻抗1M Ohms)
 输出: 1/4"单声道音频接口x2 (阻抗100 Ohms)
 采样率: 44.1K
 采样精度: 24bit
 电源供给: DC 9V (内负外正)
 电流: 170mA
 尺寸: 130*110*50mm
 重量: 425g

*免责声明: 参数更新恕不另行通知。

感谢购买我们的产品!

请仔细阅读本使用说明书和保管好本说明书以供必要时查阅。
 为了您的安全和能更快地熟练使用产品, 使用前请先仔细阅读并理解本说明书中所有的安全与使用说明。本说明书内容仅用于使用说明, 可能与实际操作本产品时有所不同。谢谢!

一. 注意事项:

- 操作开关和按键时请不要用力过当, 以免损坏本机。
- 如果表面脏了, 用干净、干燥的布擦拭。不要用苯、天拿水、洗涤剂、可燃性抛光剂等液体清洁剂。
- 请不要将本产品放在潮湿的地方, 以免损坏内部电路。
- 本产品的工作电压为DC9V, 请勿超过此电压限制, 否则将导致本产品损坏。
- 本产品出厂时不附带电源适配器, 您需要另行购买。
- 请留意您的电源适配器是否与本产品外壳上所标识的电源极性一致, 电源极性错误可能导致本产品损坏。
- 请在本产品电源连接以后, 再打开您的放大器电源。
- 不要把本机和生活垃圾一同丢弃。正确的处理可以减少环境污染和健康危害。正确的处理方法各地不同, 所以详情请联系当地官方机构。

二. 性能概述:

- 两个独立MODE模块包含18种周边调制效果。
- MODE A、MODE B各有独立可调参数。
- 2档效果连接方式可获得丰富多变的音色组合。
- 独立的TAP设速功能。
- 具有立体声输出。

三. 面板介绍:

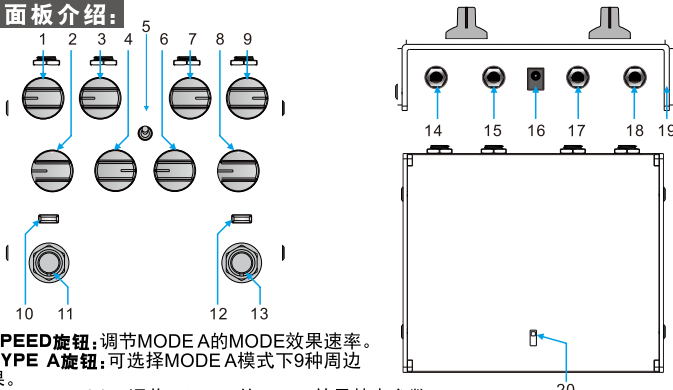

- 1. SPEED旋钮:** 调节MODE A的MODE效果速率。
- 2. TYPE A旋钮:** 可选择MODE A模式下9种周边效果。
- 3. CONTROL旋钮:** 调节MODE A的MODE效果特点参数。
- 4. DEPTH/MIX旋钮:** 调节MODE A的MODE效果深度和混合比例。
- 5. 拨档开关:** 选择MODE A和MODE B的连接方式 (具体参考 五. 线路连接)。
- 6. DEPTH/MIX旋钮:** 调节MODE B的MODE效果深度和混合比例。
- 7. RATE旋钮:** 调节MODE B的效果音颤动的快慢。
- 8. TYPE B旋钮:** 可选择MODE B模式下9种周边效果。
- 9. CONTROL旋钮:** 调节MODE B的MODE效果特点参数。
- 10. MODE A工作状态指示灯:** MODE A模式开启时, 指示灯点亮为蓝色灯长亮, 激活TAP TEMPO后, 指示灯为蓝色灯闪烁, 显示当前速率。
- 11. MODE A踩钉开关:** ①控制MODE A效果的开关。②长踩踩钉可激活TAP TEMPO模式, 激活TAP TEMPO模式后, 连续两次踩下踩钉设置MODE效果的速度。
- 12. MODE B工作状态指示灯:** MODE B模式开启时, 指示灯点亮为蓝色灯长亮, 激活TAP TEMPO后, 指示灯为蓝色灯闪烁, 显示当前速率。
- 13. MODE B踩钉开关:** ①控制MODE B效果的开关。②长踩踩钉可激活TAP TEMPO模式, 激活TAP TEMPO模式后, 连续两次踩下踩钉设置MODE效果的速度。
- 14. INPUT L 接口:** 左声道输入接口, 单声道模式时, 请连接此接口 (具体参考 四. 连接示意)。
- 15. INPUT R 接口:** 右声道输入接口。
- 16. DC IN接口:** 电源接口 (DC9V 内负外正)。
- 17. OUTPUT L 接口:** 1/4"左声道 (单声道) 输出口, 用于连接输出信号或音箱。
- 18. OUTPUT R 接口:** 1/4"右声道输出口, 用于连接输出信号或音箱。
- 19. 氛围灯:** 请参考20来设置氛围灯模式。
- 20. 氛围灯控制开关:**
 - SYNC模式--当踩钉开关开启时, 氛围灯为蓝色灯, 踩钉开关关闭时, 氛围灯不亮。
 - ALWAYS模式--氛围灯为常亮蓝色灯。
 - OFF模式--氛围灯不亮。

卓乐产品服务政策

一、在正常使用产品过程中, 如果出现非人为损坏的性能故障, 自购买之日起, 消费者享有保修服务, 保修期为12个月。
 二、有下列情况之一者, 消费者不能享受保修权益。
 1、人为损坏; 2、超过保修期; 3、无保修卡及有效发票, 但能够证明产品在保修期内的除外; 4、保修卡与产品型号不符, 或保修卡被涂改; 5、未按说明书要求使用、维护、保养而造成产品损坏; 6、未经卓乐公司授权, 擅自拆卸、维修产品、或浸水、摔坏产品; 7、其他不可抗力造成的损坏。
 三、卓乐服务信息:
 消费者服务热线: 0755-29765390
 更多信息请访问: www.joyochina.cn



卓乐产品保修卡

产品型号	购机日期	SN号码	
用户信息	姓名		
	电话		
	地址		
	发票号码		
销售单位信息	名称 (加盖公章)		
	地址		
	电话		

品牌: JOYO 名称: 效果器
 执行标准: QB/T 4324-2012
 制造商: 深圳市卓乐科技有限公司
 地址: 广东省深圳市宝安28区新安三路
 陆氏工业大厦2楼 邮编: 518133
 售后服务热线: 0755-29765390

产品合格证

检验结论: 合格
 检验员号: QC 01

Accessories